

WE DON'T DO
AVERAGE AT
LIME WOOD. THAT'S WHY
AT OUR SPA YOU
CAN DO YOGA ON THE
ROOF IN A
HERB GARDEN,
REVIVE TOGETHER IN DOUBLE
TREATMENT ROOMS
AND TAKE IN THE
FOREST
VIEWS FROM THE
MASSIVE SAUNA.



Joining us

We're really excited about what we've created at the Herb House. It's beautiful, it's unusual and it's everything a luxury and natural health spa set in the forest should be. Well, that's what we think anyway.

The Herb House at Lime Wood is inspired by and surrounded by nature so of course we want to maintain the intimacy and sense of serenity achieved by its location and design. That's why we'll have a limited number of people joining us. Membership will include a comprehensive lifestyle assessment, special rates for treatments, guest passes and full use of all spa areas. And with Raw & Cured offering natural, healthy and garden-grown food and juices, combined with the roof garden, it's a pretty dreamy place to just come and hang out too.

It's not often you can create something like the Herb House from scratch, with a fantastic team and in such a special forest location. To make sure that it's one of a kind, we've worked hard in the way we've designed the spa, the way we've kitted it out and the way we've selected specialist therapists with a holistic approach to well-being. We feel passionate about that.

We hope you'll be coming to join us.

LIMEWOOD



Printed on paper made from 100% post consumer waste and sourced in accordance with the rules of the Forest Stewardship Council®
Designed by Strattons.com

HERB HOUSE at Lime Wood
Beaulieu Rd, Lyndhurst, Hampshire SO43 7FZ
Telephone 023 8028 6998 Reservations 023 8028 6999 Fax 023 8028 7199
Email info@herbhousespa.co.uk Web www.limewood.co.uk



Herb House

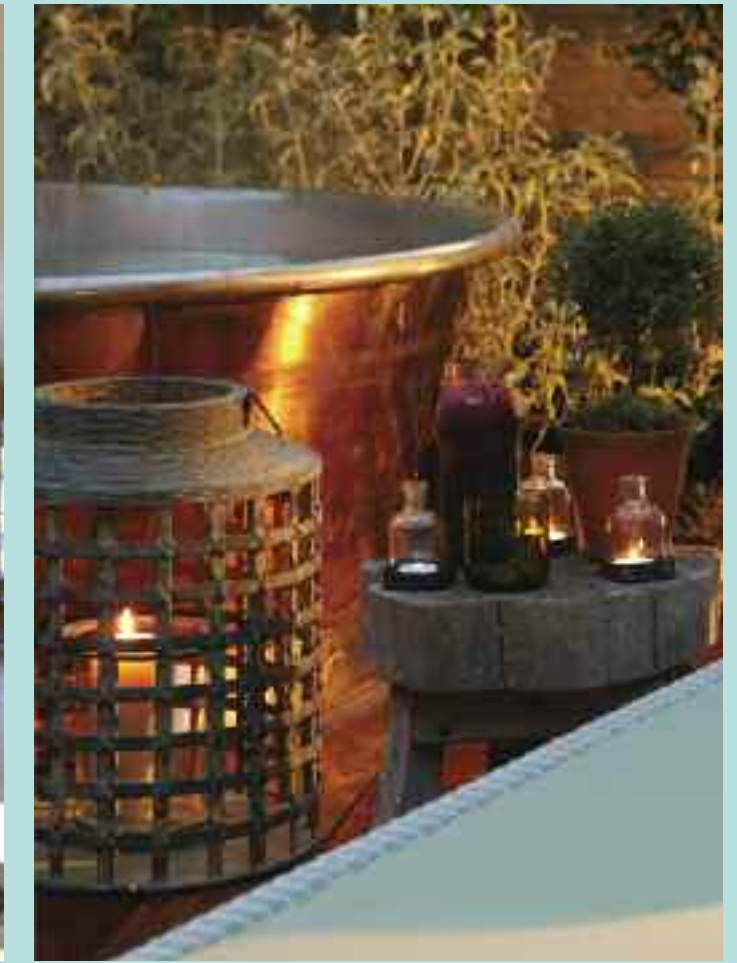

What you'll feel...

Our treatments start the moment you walk into the spa, but they don't finish when you walk out. Our expert team focuses on authentic, holistic treatments that take inspiration from centuries of well-being tradition so that you feel better, longer. From seaweed wraps to Ayurvedic Therapies to Tri Dosha, and with natural Bamford, Nude and VOYA products, our treatments are luxurious and indulgent but also health-giving and good for the soul.

What you'll find...

Yes we've gone to town with creating fantastic features like the outdoor Steaming Hot Pool, the Mud House and rooftop Technogym. But what we really love is our herbary roof garden and meditation area, the stunning forest views from the massive glass-front sauna, and the double height Bath House.



Herb House

Where it's at

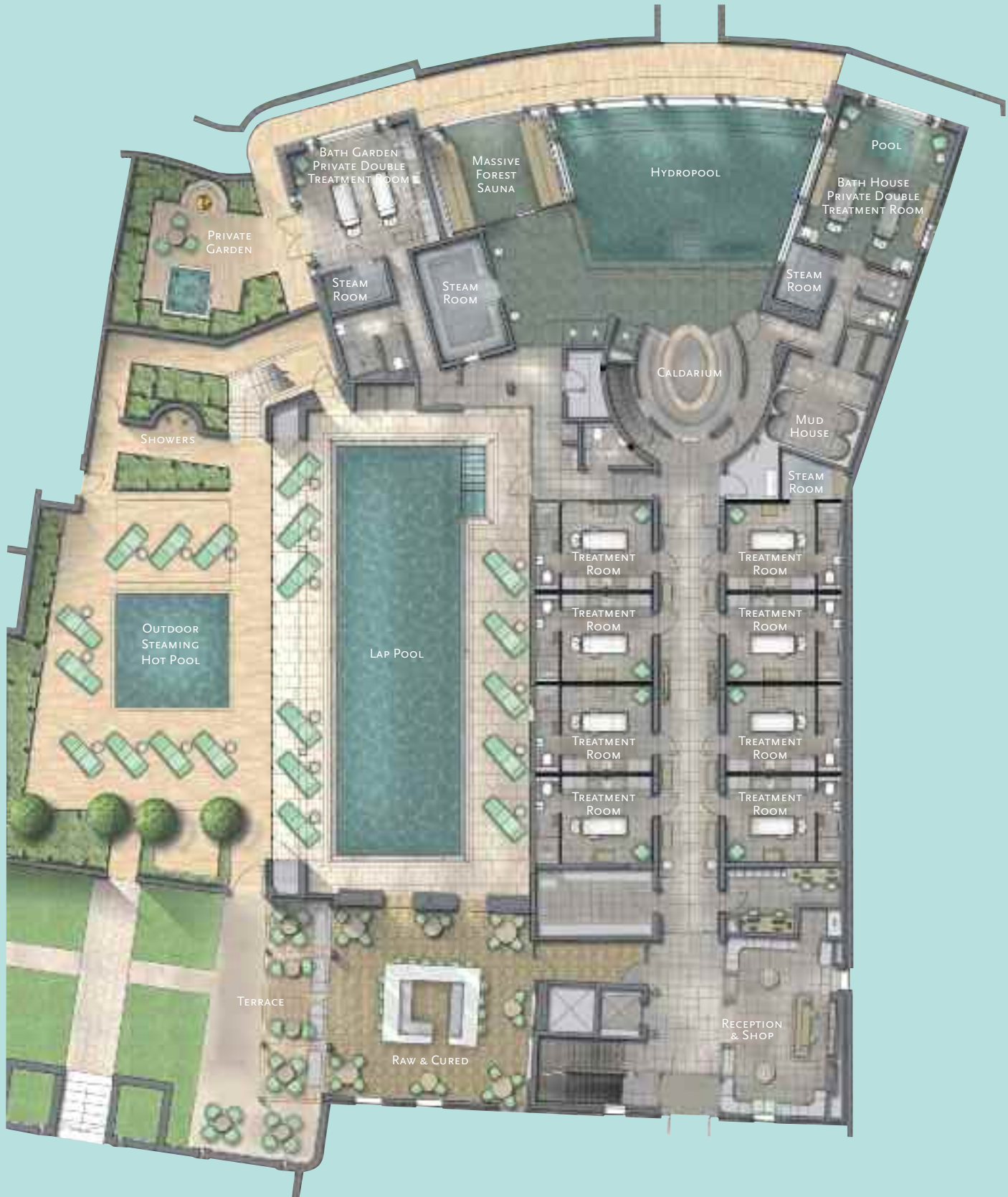

Calm below



On the top



What we've got...

- 22,000 sq ft on 3 floors
- 10 treatment rooms including
 - 1 private double treatment room with steam room and garden
 - 1 Bath House private double treatment room with indoor pool and steam room
 - 8 single treatment rooms
- Caldarium
- Hydropool
- Mud House - Rasul
- Massive Forest Sauna
- Steam House
- Outdoor Steaming Hot Pool
- Indoor swimming pool opening onto garden sun terrace
- Rooftop herbarium with sun deck and meditation areas
- Workout Studio
- State-of-the-art Technogym
- Extensive treatment list of natural and Ayurvedic therapies
- Oversized changing suites with private bathrooms
- Raw & Cured offering natural, healthy and garden-grown food and juices (and the odd glass of fizz!)
- Retail area selling Bamford, VOYA, NUDE and Tri Dosha products as well as items from Lime Wood

HERB HOUSE at Lime Wood

Beaulieu Rd, Lyndhurst, Hampshire SO43 7FZ

Telephone 023 8028 6998 Reservations 023 8028 6999 Fax 023 8028 7199

Email info@herbhousespa.co.uk Web www.limewood.co.uk

Lime Wood reserves the right to change the above plans according to requirements.